

Алматы (7273)495-231  
 Ангарск (3955)60-70-56  
 Архангельск (8182)63-90-72  
 Астрахань (8512)99-46-04  
 Барнаул (3852)73-04-60  
 Белгород (4722)40-23-64  
 Благовещенск (4162)22-76-07  
 Брянск (4832)59-03-52  
 Владивосток (423)249-28-31  
 Владикавказ (8672)28-90-48  
 Владимир (4922)49-43-18  
 Волгоград (844)278-03-48  
 Вологда (8172)26-41-59  
 Воронеж (473)204-51-73  
 Екатеринбург (343)384-55-89

Иваново (4932)77-34-06  
 Ижевск (3412)26-03-58  
 Иркутск (395)279-98-46  
 Казань (843)206-01-48  
 Калининград (4012)72-03-81  
 Калуга (4842)92-23-67  
 Кемерово (3842)65-04-62  
 Киров (8332)68-02-04  
 Коломна (4966)23-41-49  
 Кострома (4942)77-07-48  
 Краснодар (861)203-40-90  
 Красноярск (391)204-63-61  
 Курск (4712)77-13-04  
 Курган (3522)50-90-47  
 Липецк (4742)52-20-81

Магнитогорск (3519)55-03-13  
 Москва (495)268-04-70  
 Ижевск (3412)26-03-58  
 Мурманск (8152)59-64-93  
 Набережные Челны (8552)20-53-41  
 Нижний Новгород (831)429-08-12  
 Новокузнецк (3843)20-46-81  
 Ноябрьск (3496)41-32-12  
 Новосибирск (383)227-86-73  
 Омск (3812)21-46-40  
 Орел (4862)44-53-42  
 Оренбург (3532)37-68-04  
 Пенза (8412)22-31-16  
 Петрозаводск (8142)55-98-37  
 Псков (8112)59-10-37  
 Пермь (342)205-81-47

Ростов-на-Дону (863)308-18-15  
 Рязань (4912)46-61-64  
 Самара (846)206-03-16  
 Санкт-Петербург (812)309-46-40  
 Саратов (845)249-38-78  
 Севастополь (8692)22-31-93  
 Саранск (8342)22-96-24  
 Симферополь (3652)67-13-56  
 Смоленск (4812)29-41-54  
 Сочи (862)225-72-31  
 Ставрополь (8652)20-65-13  
 Сургут (3462)77-98-35  
 Сыктывкар (8212)25-95-17  
 Тамбов (4752)50-40-97  
 Тверь (4822)63-31-35

Тольятти (8482)63-91-07  
 Томск (3822)98-41-53  
 Тула (4872)33-79-87  
 Тюмень (3452)66-21-18  
 Ульяновск (8422)24-23-59  
 Улан-Удэ (3012)59-97-51  
 Уфа (347)229-48-12  
 Хабаровск (4212)92-98-04  
 Чебоксары (8352)28-53-07  
 Челябинск (351)202-03-61  
 Череповец (8202)49-02-64  
 Чита (3022)38-34-83  
 Якутск (4112)23-90-97  
 Ярославль (4852)69-52-93

Россия +7(495)268-04-70

Казахстан +7(7172)727-132

Киргизия +996(312)96-26-47

<https://kastas.nt-rt.ru/> || [ksi@nt-rt.ru](mailto:ksi@nt-rt.ru)

## K18 - COMPACT PISTON SEAL



K18 is a five piece double acting compact seal which consists of elastomeric sealing element, thermoplastic elastomer backup rings and thermoplastic guide rings. It is suitable with many hydraulic cylinders thanks to the design with low friction and superior static and dynamic sealing functionality.

### Advantages

- Superior sealing performance and low friction with its special design
- No additional guide ring requirement at low and medium duty applications thanks to compact design
- Economical sealing solution
- Simple groove design at one-piece piston
- Long service life
- Easy installation thanks to cut guide and backup rings

### Area of Application

- Agricultural machinery
- Construction machinery
- Mobile machinery
- Loading platforms
- Forklifts • Industrial cylinders

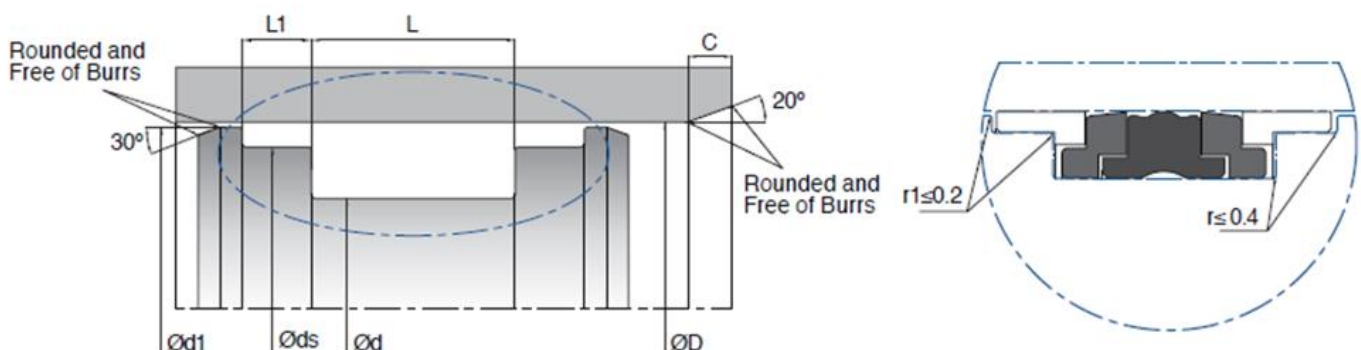

	<b>D (H8)</b>	<b>d (h9)</b>	<b>L (+0.2/-0)</b>	<b>ds (h8)</b>	<b>d1 (±0.1)</b>	<b>L1 (+0.2/-0)</b>	<b>C</b>	<b>MATERIAL</b>	<b>Kastaş CODE</b>
K18 020-011	20	11	13.5	17	19	2.1	4	NB8001	10003121
K18 022-013	22	13	13.5	19	21	2.1	4	NB8001	10003123
K18 025-015	25	15	16.4	21.45	23.5	6.35	4	NB8001	10003124
K18 025-015/1	25	15	12	21	23	4	4	NB8001	10003125
K18 025-015/2	25	15	12.5	22	24	4	4	NB8001	10003126
K18 025-016	25	16	13.5	22	24	2.1	4	NB8001	10003127
K18 025-017/1	25	17	13.5	21	24.4	3.2	4	NB8001	10003130
K18 025-017/2	25	17	10	22	24	4	4	NB8001	10003131
K18 028-019	28	19	13.5	25	27	2.1	4	NB8001	10003133
K18 030-017	30	17	15.4	26.5	28.5	6.35	4	NB8001	10003134
K18 030-021	30	21	13.5	27	29	2.1	4	NB8001	10003136
K18 030-022	30	22	13.5	26	29.4	3.2	4	NB8001	10003137
K18 032-019	32	19	15.4	28.5	30.7	6.35	4	NB8001	10003138
K18 032-022	32	22	16.4	28.5	30.5	6.35	4	NB8001	10003139
K18 032-022/1	32	22	15.5	28	31	2.6	4	NB8001	10003140
K18 032-022/2	32	22	12.5	29	31	4	4	NB8001	10003143
K18 032-024	32	24	15.5	28	31	3.1	4	NB8001	10003145
K18 032-024/1	32	24	10	29	31	4	4	NB8001	10003147
K18 035-025	35	25	16.4	31.4	33.5	6.35	4	NB8001	10003149
K18 035-027	35	27	15.5	31	34.4	3.2	4	NB8001	10003151
K18 038.1-025.4	38.1	25.4	15.87	34.54	37.08	6.35	4	NB8001	10003153
K18 040-	40	24	18.4	35.4	38.5	6.35	5	NB8001	10003155

	D (H8)	d (h9)	L (+0.2/-0)	ds (h8)	d1 ( $\pm 0.1$ )	L1 (+0.2/-0)	C	MATERIAL	Kastaş CODE
024									
K18 040-026	40	26	15.5	36	39	2.6	4.5	NB8001	10003158
K18 040-030	40	30	16.4	35.4	38.5	6.35	4	NB8001	10003161
K18 040-030/1	40	30	12.5	37	39	4	4	NB8001	10003164
K18 040-030/2	40	30	12.4	36	39	4	4	NB8001	10003167
K18 040-032	40	32	15.5	36	39.4	3.2	4	NB8001	10003169
K18 040-032/1	40	32	10	37	39	4	4	NB8001	10003171
K18 042-028	42	28	15.5	38	41	2.6	4.5	NB8001	10003173
K18 044.45-028.57	44.45	28.57	19.05	39.85	43.12	6.35	5	NB8001	10003174
K18 045-029	45	29	18.4	40.4	43.5	6.35	5	NB8001	10003175
K18 045-031	45	31	15.5	41	44	2.6	4.5	NB8001	10003177
K18 045-035	45	35	16.4	40.4	43.5	6.35	4	NB8001	10003179
K18 045-037	45	37	15.5	41	44.4	3.2	4	NB8001	10003182
K18 050-034	50	34	20.5	46	49	3.1	5	NB8001	10003185
K18 050-034/1	50	34	18.4	45.41	48.66	6.35	5	NB8001	10003188
K18 050-035	50	35	20	46	48.5	5	5	NB8001	10003192
K18 050-038	50	38	20.5	46	49.4	4.2	4	NB8001	10003194
K18 050-040	50	40	12.5	47	49	4	4	NB8001	10003197
K18 050.8-034.92	50.8	34.92	19.05	46.23	49.48	6.35	5	NB8001	10003183
K18 050.8-041.27	50.8	41.27	11.1	46.27	49.19	3.81	4	NB8001	10003184
K18 055-039	55	39	20.5	51	54	3.1	5	NB8001	10003200

	D (H8)	d (h9)	L (+0.2/-0)	ds (h8)	d1 (±0.1)	L1 (+0.2/-0)	C	MATERIAL	Kastaş CODE
K18 055-039/1	55	39	18.4	50.37	53.65	6.35	5	NB8001	10003202
K18 055-045	55	45	12.5	52	54	4	4	NB8001	10003205
K18 056-040	56	40	20.5	52	55	3.1	5	NB8001	10003206
K18 057.15-041.27	57.15	41.27	19.05	52.55	55.8	6.35	5	NB8001	10003207
K18 060-044	60	44	20.5	56	59	3.1	5	NB8001	10003209
K18 060-044/1	60	44	18.4	55.39	58.65	6.35	5	NB8001	10003213
K18 060-048	60	48	20.5	56	58.98	4.2	4	NB8001	10003217
K18 060.32-044.45	60.32	44.45	19.05	55.72	58.98	6.35	5	NB8001	10003208
K18 063-047	63	47	20.5	59	62	3.1	5	NB8001	10003222
K18 063-047/1	63	47	18.4	58.39	61.63	6.35	55	NB8001	10003225
K18 063-047/2	63	47	19.4	58.47	61.5	6.35	5	NB8001	10003228
K18 063-048	63	48	20	59	61.5	5	5	NB8001	10003231
K18 063-051	63	51	20.5	59	62.4	4.2	4	NB8001	10003234
K18 063-053	63	53	12.5	60	62	4	4	NB8001	10003237
K18 063.5-047.62	63.5	47.62	19.05	58.9	62.12	6.35	5	NB8001	10003219
K18 063.5-053.97	63.5	53.97	11.1	59.12	62.12	3.81	4	NB8001	10003220
K18 063.5-053.97/1	63.5	53.97	11.1	58.92	61.9	3.81	4	NB8001	10003221
K18 065-049	65	49	20.5	61	64	3.1	5	NB8001	10003239
K18 065-050	65	50	18.4	60.41	63.64	6.35	5	NB8001	10003242
K18 066.67-	66.67	50.8	19.05	62.1	65.27	6.35	5	NB8001	10003245

	D (H8)	d (h9)	L (+0.2/-0)	ds (h8)	d1 ( $\pm 0.1$ )	L1 (+0.2/-0)	C	MATERIAL	Kastaş CODE
050.80									
K18 067-051	67	51	18.4	62.4	65.6	6.35	5	NB8001	10003246
K18 069.85-050.8	69.85	50.8	23.79	64.07	68.85	6.35	5	NB8001	10003247
K18 070-050	70	50	22.4	64.18	68.34	6.35	6	NB8001	10003248
K18 070-054	70	54	20.5	66	69	3.1	5	NB8001	10003252
K18 070-055	70	55	20	66	68.5	5	5	NB8001	10003257
K18 070-058	70	58	20.5	66	69.4	4.2	4	NB8001	10003258
K18 075-055	75	55	22.4	69.2	73.3	6.35	6	NB8001	10003261
K18 075-059	75	59	20.5	71	74	3.1	5	NB8001	10003265
K18 076.2-057.15	76.2	57.1 5	24.21	70.38	74.5	6.35	5	NB8001	10003267
K18 076.2-060.32	76.2	60.3 2	19.05	70.96	74.16	6.35	5	NB8001	10003268
K18 076.2-066.67	76.2	66.6 7	11.1	71.62	74.6	3.81	4	NB8001	10003269
K18 080-060	80	60	22.4	74.15	78.3	6.35	6	NB8001	10003271
K18 080-060/1	80	60	35	72.62	77.54	9.52	6	NB8001	10003275
K18 080-060/2	80	60	25	75	78	6.35	6	NB8001	10003277
K18 080-062	80	62	22.5	76	79	3.6	5	NB8001	10003280
K18 080-065	80	65	20	76	78.5	5	5	NB8001	10003283
K18 080-066	80	66	22.4	76	79.4	5.2	4.5	NB8001	10003285
K18 082.55-063.5	82.55	63.5	24.21	76.73	80.9	6.35	5	NB8001	10003287
K18 085-065	85	65	22.4	79.15	83.3	6.35	6	NB8001	10003288
K18 085-	85	65	21.4	79.15	83.3	6.35	6	NB8001	10003291

	D (H8)	d (h9)	L (+0.2/-0)	ds (h8)	d1 (±0.1)	L1 (+0.2/-0)	C	MATERIAL	Kastaş CODE
065/1									
K18 085-075	85	75	20	81	83.35	4	4	NB8001	10003293
K18 088.9-069.85	88.9	69.8 <sub>5</sub>	24.21	83.08	87.22	6.35	5	NB8001	10003294
K18 088.9-069.85/1	88.9	69.8 <sub>5</sub>	30.15	82.16	87.29	6.35	5	NB8001	10003295
K18 088.9-076.2	88.9	76.2	14.27	82.93	87.3	5.33	4	NB8001	10003296
K18 090-070	90	70	22.4	84.15	88.3	6.35	6	NB8001	10003297
K18 090-072	90	72	22.5	86	89	3.2	5	NB8001	10003300
K18 090-072/1	90	72	22.5	86	89	3.6	5	NB8001	10003302
K18 090-075	90	75	20	86	88.5	5	5	NB8001	10003304
K18 090-076	90	76	22.4	86	89.4	5.2	4.5	NB8001	10003305
K18 095-075	95	75	22.4	89.15	93.31	6.5	6	NB8001	10003308
K18 095-081	95	81	22.4	91	94.4	5.2	4.5	NB8001	10003309
K18 100-075	100	75	22.4	93.13	98	6.35	6	NB8001	10003310
K18 100-080	100	80	25.4	95	98	6.35	6	NB8001	10003314
K18 100-080/1	100	80	35	92.61	97.51	9.52	6	NB8001	10003316
K18 100-080/2	100	80	25	95	98	6.35	6	NB8001	10003318
K18 100-082	100	82	22.5	96	99	3.6	5	NB8001	10003319
K18 100-085	100	85	20	96	98.5	5	5	NB8001	10003322
K18 100-086	100	86	22.4	96	99.4	5.2	4.5	NB8001	10003324
K18 101.6-082.55	101.6	82.5 <sub>5</sub>	23.81	95.76	100.07	6.35	5	NB8001	10003327
K18 105-080	105	80	22.4	98.1	103	6.5	6	NB8001	10003329

	D (H8)	d (h9)	L (+0.2/-0)	ds (h8)	d1 ( $\pm 0.1$ )	L1 (+0.2/-0)	C	MATERIAL	Kastaş CODE
K18 105-080/1	105	80	22.4	98.1	103	6.35	6	NB8001	10003331
K18 107.95-088.9	107.95	88.9	23.81	102.08	106.23	6.35	5	NB8001	10003332
K18 110-085	110	85	22.4	103.1	108	6.35	6	NB8001	10003333
K18 110-085/1	110	85	25.4	103.1	108	6.35	6	NB8001	10003337
K18 110-090	110	90	35	102.6	107.51	9.52	6	NB8001	10003338
K18 110-090/1	110	90	25.3	104.1	108.3	6.4	6	NB8001	10003339
K18 110-092	110	92	22.5	106	109	3.6	5	NB8001	10003340
K18 110-095	110	95	20	105	108	5	5	NB8001	10003342
K18 110-096	110	96	22.4	106	109.4	5.2	4.5	NB8001	10003343
K18 114.3-088.9	114.3	88.9	31.75	107.42	112.33	6.35	6	NB8001	10003345
K18 115-090	115	90	22.4	108.1	113.02	6.35	6	NB8001	10003346
K18 115-097	115	97	22.4	111	114	4.2	5	NB8001	10003348
K18 115-097/1	115	97	22.5	111	114	3.6	5	NB8001	10003350
K18 115-101	115	101	22.4	111	114.4	5.2	4.5	NB8001	10003351
K18 120-095	120	95	22.4	113.1	118	6.35	6	NB8001	10003353
K18 120-100	120	100	35	112.8	117.5	9.5	6	NB8001	10003357
K18 120-106	120	106	22.4	116	119.4	5.2	4.5	NB8001	10003358
K18 125-100	125	100	25.4	118.1	123	6.35	6	NB8001	10003360
K18 125-100/1	125	100	45	116.82	122.33	12.7	6	NB8001	10003363
K18 125-100/2	125	100	32	119	123	10	6	NB8001	10003365
K18 125-103	125	103	26.5	121	124	5.1	6	NB8001	10003366

	D (H8)	d (h9)	L (+0.2/-0)	ds (h8)	d1 ( $\pm 0.1$ )	L1 (+0.2/-0)	C	MATERIAL	Kastaş CODE
K18 125-105	125	105	25.4	120	123	6.35	6	NB8001	10003368
K18 125-105/1	125	105	25	120	123	6.35	6	NB8001	10003370
K18 125-108	125	108	26.5	121	124.4	7.2	5	NB8001	10003372
K18 127-101.6	127	101.6	32.15	120.09	124.98	9.52	6	NB8001	10003374
K18 127-101.6/1	127	101.6	32.15	120.09	124.98	6.35	6	NB8001	10003375
K18 130-105	130	105	25.4	123.1	128	6.35	6	NB8001	10003376
K18 130-105/1	130	105	25.4	123.1	128	9.52	6	NB8001	10003379
K18 130-105/2	130	105	25.4	122.6	118.4	9.52	6	NB8001	10003381
K18 133.35-107.95	133.35	107.95	31.75	126.42	131.3	6.35	6	NB8001	10003383
K18 135-110	135	110	25.4	127.6	132.5	9.52	6	NB8001	10003384
K18 135-110/1	135	110	25.4	128.1	133	6.35	6	NB8001	10003385
K18 139.7-114.3	139.7	114.3	31.75	132.4	137.2	9.5	6	NB8001	10003386
K18 139.7-114.3/1	139.7	114.3	31.75	132.4	137.2	6.5	6	NB8001	10003387
K18 140-115	140	115	25.4	132.6	137.5	6.35	6	NB8001	10003388
K18 140-115/1	140	115	25.4	132.6	137.5	9.52	6	NB8001	10003390
K18 140-115/2	140	115	25.4	133	138	6.35	6	NB8001	10003393
K18 140-115/4	140	115	45	131.7	137.36	12.7	6	NB8001	10003396
K18 140-115/5	140	115	32	134	138	10	6	NB8001	10003397
K18 140-118	140	118	26.5	136	139	5.1	6	NB8001	10003399
K18 140-120	140	120	25	135	138	6.35	6	NB8001	10003402
K18 140-123	140	123	26.5	136	139.4	7.2	5	NB8001	10003404



	<b>D (H8)</b>	<b>d (h9)</b>	<b>L (+0.2/-0)</b>	<b>ds (h8)</b>	<b>d1 (±0.1)</b>	<b>L1 (+0.2/-0)</b>	<b>C</b>	<b>MATERIAL</b>	<b>Kastaş CODE</b>
K18 145-120	145	120	25.4	137.6	142.5	9.52	6	NB8001	10003406
K18 150-125	150	125	25.4	142.6	147.5	9.5	6	NB8001	10003408
K18 150-125/1	150	125	25.4	143	148	6.35	6	NB8001	10003410
K18 150-128	150	128	26.5	146	149	5.1	6	NB8001	10003413
K18 150-130	150	130	25.4	144.1	148.3	6.35	6	NB8001	10003415
K18 150-133	150	133	26.5	146	149.4	7.2	5	NB8001	10003416
K18 152.4-127	152.4	127	31.75	145	149.91	9.52	6	NB8001	10003417
K18 152.4-127/1	152.4	127	38.1	145.69	150.79	9.52	6	NB8001	10003419
K18 155-130	155	130	25.4	148	153	6.35	6	NB8001	10003420
K18 155-130/1	155	130	25.4	147.6	152.5	9.52	6	NB8001	10003422
K18 160-130	160	130	25.4	153	157.5	6.35	6	NB8001	10003424
K18 160-130/1	160	130	25.4	152.6	157.5	9.52	6	NB8001	10003427
K18 160-130/2	160	130	25.4	153	157.5	9.52	6	NB8001	10003428
K18 160-135	160	135	25.4	152.6	157.5	9.52	6	NB8001	10003429
K18 160-135/1	160	135	45	151.72	157.1	12.7	6	NB8001	10003431
K18 160-135/2	160	135	32	154	158	10	6	NB8001	10003433
K18 160-138	160	138	26.5	156	159	5.1	6	NB8001	10003434
K18 160-140	160	140	25	155	158	6.35	6	NB8001	10003437
K18 160-143	160	143	26.5	156	159.4	7.2	5	NB8001	10003439
K18 165-140	165	140	25.4	157.6	162.5	9.52	6	NB8001	10003443
K18 165-143	165	143	26.5	161	163.5	5.25	6	NB8001	10003444

	D (H8)	d (h9)	L (+0.2/-0)	ds (h8)	d1 ( $\pm 0.1$ )	L1 (+0.2/-0)	C	MATERIAL	Kastaş CODE
K18 165.1-139.62	165.1	139.62	32.5	158.14	163	6.45	6	NB8001	10003441
K18 165.1-139.7	165.1	139.7	31.9	157.82	162.6	6.45	6	NB8001	10003442
K18 170-140	170	140	25.4	163	168	6.4	6	NB8001	10003446
K18 170-145	170	145	25.4	161.72	167.1	12.7	6	NB8001	10003447
K18 170-148	170	148	26.5	166	169	5.1	6	NB8001	10003448
K18 175-150	175	150	25.4	166.72	172.1	12.7	6	NB8001	10003449
K18 177.8-152.4	177.8	152.4	31.75	170.51	175.52	9.52	6	NB8001	10003450
K18 177.8-152.4/1	177.8	152.4	31.75	170.52	175.52	6.45	6	NB8001	10003451
K18 180-150	180	150	35.4	172.95	177.87	6.35	6	NB8001	10003452
K18 180-150/1	180	150	36	172	177.87	12.5	6	NB8001	10003454
K18 180-155	180	155	25.4	171.72	177.1	12.7	6	NB8001	10003455
K18 180-158	180	158	26.5	176	179	5.1	6	NB8001	10003457
K18 180-163	180	163	26.5	176	179.4	7.2	5	NB8001	10003459
K18 185-160	185	160	25.4	176.72	182.1	12.7	6	NB8001	10003461
K18 190-165	190	165	25.4	181.72	187.05	12.7	6	NB8001	10003462
K18 195-170	195	170	25.4	187.1	192.05	12.7	6	NB8001	10003464
K18 200-170	200	170	35.4	193	198	6.35	6	NB8001	10003466
K18 200-170/1	200	170	36	192	197	12.5	6	NB8001	10003469
K18 200-175	200	175	31.5	196	199	6.6	6	NB8001	10003471
K18 200-175/1	200	175	25.4	191.62	197	12.7	6	NB8001	10003474
K18 200-	200	180	31.5	196	199.4	9.2	6	NB8001	10003476

	D (H8)	d (h9)	L (+0.2/-0)	ds (h8)	d1 ( $\pm 0.1$ )	L1 (+0.2/-0)	C	MATERIAL	Kastaş CODE
180									
K18 203.2-171.45	203.2	171.45	38.1	195.09	201.17	8	6	NB8001	10003479
K18 203.2-177.8	203.2	177.8	31.75	196.16	201.18	9.52	6	NB8001	10003480
K18 203.2-177.8/1	203.2	177.8	31.75	196.16	201.1	6.35	6	NB8001	10003481
K18 210-185	210	185	25.4	201.62	207	12.7	6	NB8001	10003482
K18 220-190	220	190	35.4	212.7	217.9	6.35	6	NB8001	10003483
K18 220-190/1	220	190	35.4	213.5	217.9	6.35	6	NB8001	10003485
K18 220-195	220	195	25.4	211.62	217	12.7	6	NB8001	10003486
K18 220-200	220	200	31.5	216	219.4	9.2	6	NB8001	10003487
K18 225-195	225	195	35.5	218	223	6.35	6	NB8001	10003489
K18 225-200	225	200	31.5	221	224	6.6	6	NB8001	10003490
K18 225-200/1	225	200	25.4	216.6	223	12.7	6	NB8001	10003491
K18 230-205	230	205	25.4	221.62	227	12.7	6	NB8001	10003492
K18 240-215	240	215	25.4	231.62	237	12.7	6	NB8001	10003493
K18 250-220	250	220	35.4	242.9	247.85	6.35	6	NB8001	10003494
K18 250-225	250	225	25.4	241.62	247	12.7	6	NB8001	10003496
K18 250-230	250	230	31.5	246	249.4	9.2	6	NB8001	10003500
K18 260-235	260	235	35.4	252.9	257	12.7	6	NB8001	10003502
K18 280-250	280	250	36.4	273	278	10	6	NB8001	10003504
K18 280-250/1	280	250	35.4	272.9	277.85	9.52	6	NB8001	10003506

**Алматы** (7273)495-231  
**Ангарск** (3955)60-70-56  
**Архангельск** (8182)63-90-72  
**Астрахань** (8512)99-46-04  
**Барнаул** (3852)73-04-60  
**Белгород** (4722)40-23-64  
**Благовещенск** (4162)22-76-07  
**Брянск** (4832)59-03-52  
**Владивосток** (423)249-28-31  
**Владикавказ** (8672)28-90-48  
**Владимир** (4922)49-43-18  
**Волгоград** (844)278-03-48  
**Вологда** (8172)26-41-59  
**Воронеж** (473)204-51-73  
**Екатеринбург** (343)384-55-89

**Иваново** (4932)77-34-06  
**Ижевск** (3412)26-03-58  
**Иркутск** (395)279-98-46  
**Казань** (843)206-01-48  
**Калининград** (4012)72-03-81  
**Калуга** (4842)92-23-67  
**Кемерово** (3842)65-04-62  
**Киров** (8332)68-02-04  
**Коломна** (4966)23-41-49  
**Кострома** (4942)77-07-48  
**Краснодар** (861)203-40-90  
**Красноярск** (391)204-63-61  
**Курск** (4712)77-13-04  
**Курган** (352)50-90-47  
**Липецк** (4742)52-20-81

**Магнитогорск** (3519)55-03-13  
**Москва** (495)268-04-70  
**Мурманск** (8152)59-64-93  
**Набережные Челны** (8552)20-53-41  
**Нижний Новгород** (831)429-08-12  
**Новокузнецк** (3843)20-46-81  
**Ноябрьск** (3496)41-32-12  
**Новосибирск** (383)227-86-73  
**Омск** (3812)21-46-40  
**Орел** (4862)44-53-42  
**Оренбург** (3532)37-68-04  
**Пенза** (8412)22-31-16  
**Петрозаводск** (8142)55-98-37  
**Псков** (8112)59-10-37  
**Пермь** (342)205-81-47

**Ростов-на-Дону** (863)308-18-15  
**Рязань** (4912)46-61-64  
**Самара** (846)206-03-16  
**Санкт-Петербург** (812)309-46-40  
**Саратов** (845)249-38-78  
**Севастополь** (8692)22-31-93  
**Саранск** (8342)22-96-24  
**Симферополь** (3652)67-13-56  
**Смоленск** (4812)29-41-54  
**Сочи** (862)225-72-31  
**Ставрополь** (8652)20-65-13  
**Сургут** (3462)77-98-35  
**Сыктывкар** (8212)25-95-17  
**Тамбов** (4752)50-40-97  
**Тверь** (4822)63-31-35

**Тольятти** (8482)63-91-07  
**Томск** (3822)98-41-53  
**Тула** (4872)33-79-87  
**Тюмень** (3452)66-21-18  
**Ульяновск** (8422)24-23-59  
**Улан-Удэ** (3012)59-97-51  
**Уфа** (347)229-48-12  
**Хабаровск** (4212)92-98-04  
**Чебоксары** (8352)28-53-07  
**Челябинск** (351)202-03-61  
**Череповец** (8202)49-02-64  
**Чита** (3022)38-34-83  
**Якутск** (4112)23-90-97  
**Ярославль** (4852)69-52-93

**Россия** +7(495)268-04-70

**Казахстан** +7(7172)727-132

**Киргизия** +996(312)96-26-47

<https://kastas.nt-rt.ru/> || [ksi@nt-rt.ru](mailto:ksi@nt-rt.ru)